

Rationale Document

Amanda Lanning



Biology
October 12, 2007

Key

- lights
- table
- chairs
- Flamingos
- White Arbor
- Hammock
- Fire Pit
- Gazing Ball
- Isabelle Bloom Statue
- mailbox
- Bird Feeder
- Bird Bath
- pool
- Flower Garden
- Tree
- Mulch
- grass

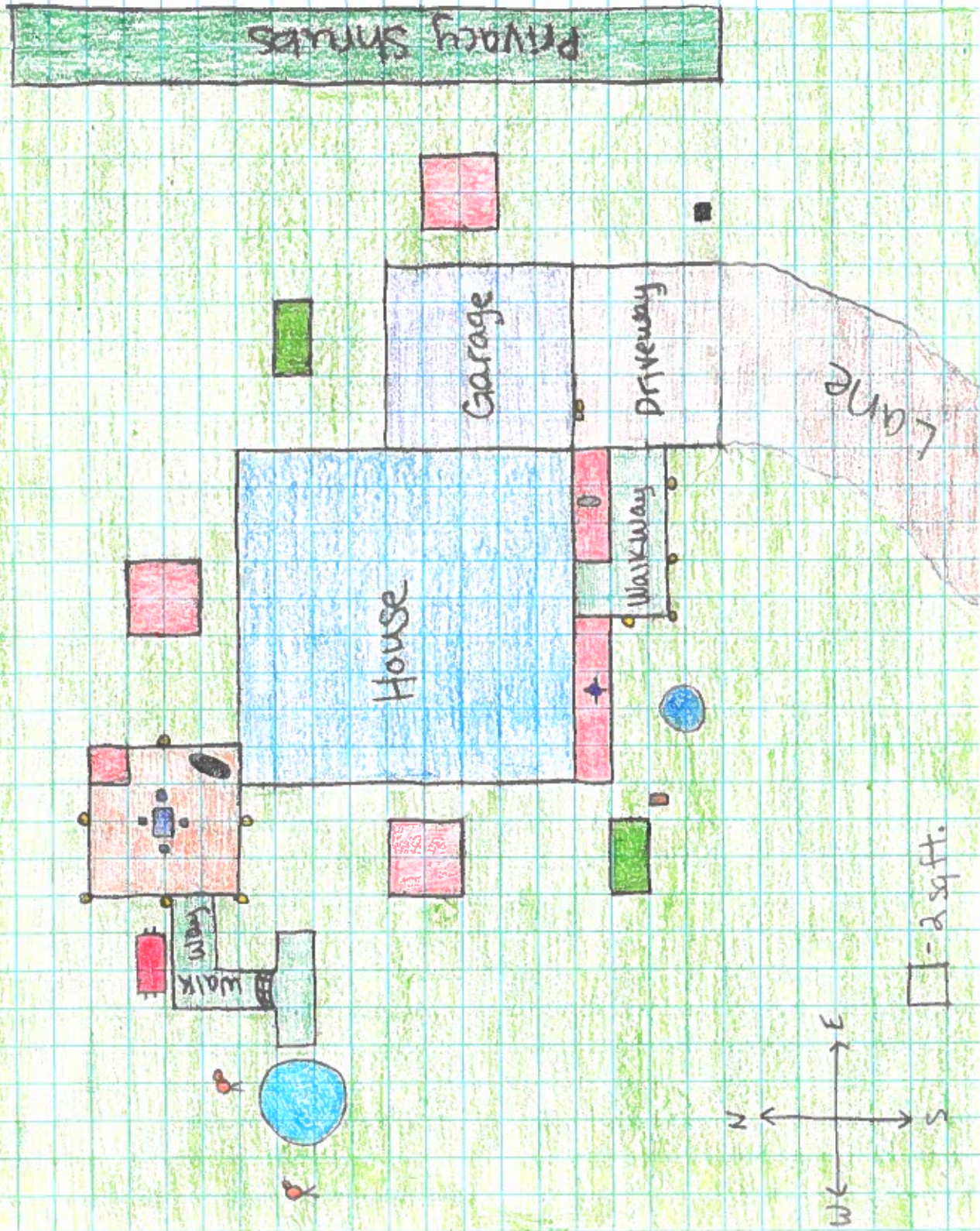

Landscaping

I. Flower Garden:

1) Description:

Ruby Giant Coneflowers have pink petals. Primadonna White has white petals. Helleborus Royal Heritage has many different types of colored petals. Echunacea Pixie looks like the Ruby Giants but their petals aren't as long. Agapanthus "Storm Cloud" is blue and there are many flowers on one stem. White Star Grass looks like really tall grass with small white flowers on the top. Chilean Jasmine has medium sized flowers with five white petals. Camelia Nuccio's Pearl looks like a big rose with white petals blended with pink. Eureka Variegate Pink Lemon is a fruit bearing flower. The fruit is green on the outside but an orange color in the middle. Potentilla Fruticosa has small flowers with orange petals.

2) Justification:

The reason why I chose all of my flowers that I did is because I wanted many arrangements of colors. I also chose the fruit bearing flower because I wanted to have some type of plant that I would have to keep an eye on so that the fruits can be produced. I put these flowers in the place that I did because I thought it would be nice to but flowers all over the yard but also spread them out. The way that I put all my flowers, I can see where they grow the best because they are on the North, South, East, and West sides of my house.

3) Price Estimates:

Ruby Giant Coneflowers: \$13.00

Primadonna White: \$15.00

Helleborus Royal Heritage: \$13.00

Echinacea Pixie: \$13.00

Agapanthus "Storm Cloud": \$13.00

White Star Grass: \$9.00

Chilean Jasmine: \$24.00

Camelia Nuccio's Pearl: \$25.00

Eureka Variegated Pink Lemon: \$30.00

Potentilla Fruticosa "Sunset": \$25.00

4) Store Location:

All the flowers that I have selected I got at Home Depot.

II. Trees:

1) Description:

Autumn Purple Ash is about 50-70 feet tall. It has green panicle flowers. It grows at a rapid speed. In the fall the leaves turn purple. A chestnut oak is about 60-70 feet tall. The flower color is yellowish-green. It grows at a moderate speed. The colors of the leaves in the fall are yellow and red.

2) Justification:

I chose the autumn purple ash because it grows at a faster speed and it gives a lot of shade. I put it where it is because it shades some of my flowers and it also shades the bird bath so the water can be cool for the birds. I chose the chestnut oak because it grows to be very tall and it provides a lot of shade.

3) Price Estimates:

Autumn Purple Ash: \$37.95

Chestnut Oak: \$15.45

4) Store Location:

I got both of my trees at www.naturehill.com.

III. Grass:

1) Descriptions:

This grass grows rapidly. It's green.

2) Justification:

I got this kind of grass because the information about this grass said it grows well in the Central America.

3) Price Estimates:

Pennington Grass Seed: \$23.98

4) Store Location:

I got my grass at Lowes.

IV. Exterior Lighting:

1) Description:

The motion light has six sides and it's a chrome color. Whenever something moves past it, it turns on. The walkway lights are small and black. They are stuck into the ground around the walkway coming out of the house and around the social area.

2) Justification:

I used a motion light because when people walk around they need to be able to see and usually when you get home at night you come in from the garage and they need to see where they are going. I put the walkway lights around the walkway coming and leaving the house so that people can see when they are coming in and leaving if it's dark out. I also put the walkway lights around the social area so when people are sitting out there late at night they are able to see each other.

3) Price Estimates:

Motion Light: \$44.38

Walkway Lights: \$ 65.67

4) Store Location:

I got all my lights at Lowes.

V. Water Device:

1) Description:

The bird bath is wide around the base and it thins going up. It has got a nice design around the stump of the bird bath. The pool is about 4 foot deep. It can fit a family of 6 in it.

2) Justification:

I am using this bird bath because it makes my yard look decorative and it helps the birds with cooling off. I put it there because it's close to a tree and the tree will shade the water to keep it cool. I am using a pool so that there can be some amassment.

3) Price Estimates:

Bird Bath: \$39.97

Pool: \$169.99

4) Store Location:

I got my bird bath at Lowes. I got the pool from Ace.

VI. Landscaping Trim:

1) Description:

The brick is a dark color and one end of it is rounded and the other end is curved in. You have to place these bricks down a certain way to they make a design.

2) Justification:

I chose this trim because it has a nice design to it. You have to stack this type of brick certain way. I placed these bricks around my flower beds so that none of the soil blows away and the flowers stay intact.

3) Price Estimates:

Bricks: \$33.32

4) Store Location:

I got the bricks at Lowes.

VII. Outdoor Social Area:

1) Description:

The mulch is brown and it will cover up the whole outdoor social area. The table and chair set contain 4 chairs and one table. They are black and silver. The arbor is white and it goes at the entrance of the social area. I have a fire pit so when there is company over we can sit outside and sit around the fire and maybe make some food. I got a hammock so on a nice day someone can go out and lay on it.

2) Justification:

I used the mulch because it looked nice and it was not expensive. I picked out a table and chairs because when people come over they can sit in the chairs and not on the ground. I used the arbor because it just completes the social area when you walk into it. I chose the fire pit because it's nice to be around at night. I chose the hammock so people can relax. I put all this stuff in or around the social area because all the stuff you use, you use it while other people are around.

3) Price Estimates:

Mulch: \$23.94

Table and chairs: \$269.70

Summer Breeze White Arbor: \$219.00

Round Fire Pit: \$149.99

Deluxe Hammock Swing: \$239.99

4) Store Location:

I got the mulch and summer breeze white arbor at Lowes. I got the table and chairs at Home Depot. I got the fire pit and the hammock and Ace.

VIII. Fencing:

1) Description:

The Azalea Autumn Belle grows really big and it blooms flowers that are pink and there are 5 petals.

2) Justification:

I used these privacy shrubs because they grow really big and they also provide a nice appearance. I placed these where they are because it blocks the road from seeing my house.

3) Price Estimates:

Azalea Autumn Belle: \$144.00

4) Store Location:

I got the privacy shrubs at Home Depot.

IX. Walkway:

1) Description:

My walkway is made up off little river stones. They come in different shapes and sizes. They are brown and circular.

2) Justification:

I chose the river rocks because they are easy to walk on and you wouldn't trip over them. You might kick them out of the walkway but you can always put them back in the path.

3) Price Estimates:

River Rocks: \$4.98

4) Store Location:

I got the river rocks at Lowes.

X. Extra Material:

1) Description:

The mailbox is tall and black. It has two different openings so the mail can go in one of them and the newspaper can go in the other. There is also a red flag on it. The gazing ball is standing on a brass stand and the ball is a purple/blue color. The Isabelle Bloom statue is two kids that look like they were just playing in the garden. The bird feeder has three different tubes that you can put three different typed of seed in them. The flamingo is pink and it has a fan on the side to make it look like wings.

2) Justification:

I chose the mailbox so I have something that my mail can go in. I put it by the garage because the garage is by the road and the mailman delivers the mail on the road. I got the gazing ball because it makes the yard decorative. I put it by the flowers. I chose the Isabelle Bloom statue because it is garden looking. I put it by a different patch of flowers so it makes it look more like a garden. I got a bird feeder so the birds have something to eat out of when they are in the bird bath. Also so I can watch the birds eat out of it. I put it close to the bird bath so the birds know that they can eat and then go in the water. I got the flamingos because it gives the yard a decorative look.

3) Price Estimates:

Mailbox: \$52.97

Gazing Ball: \$17.97

Isabelle Bloom Statue: \$39.00

Bird Feeder: \$46.99

Flamingo: \$215.56

4) Store Location:

I got the mailbox at Home Depot. I got the gazing ball at Lowes. I got the bird feeder and the flamingo at Ace. I got the Isabelle Bloom statue at www.carolinacreekgiftbaskets.com.

Work Cited

- www.homedepot.com
- www.lowes.com
- www.naturehill.com
- www.carolinacreekgiftbaskets.com

Picture:

- <http://silviahartmann.com/background-tile/images/1-colorful-flowers-background.jpg>

Pictures

I. Flowers:

1) Ruby Giants Coneflowers:



2) Primadonna White:



3) Helleborus Royal Heritage:



4) **Echinacea Pixie:**



5) **Agapanthus "Storm Cloud":**



6) **White Star Grass:**



7) Chilean Jasmine:



8) Camelia Nuccio's Pearl:



9) Eureka Variegate Pink Lemon:



10) Potentilla Fruticosa 'Sunset':



II. Trees:

1) Autumn Purple Ash:



2) Chestnut Oak:



III. Grass:

Pennington Grass Seed (Central):



IV. Exterior Lighting:

1) Desa Motion Light:



2) Walkway Lights:



V. Water Device:

1) Bird Bath:



2) Metal Frame Pool Set:



VI. Landscaping Trim:

Brick Block:



VII. Outside Social Area:

1) Mulch:



2) Table and Chair Set:



3) Summer Breeze White Arbor:



4) Round Fire Pit:



5) Deluxe Hammock Swing:



VIII: Privacy Fencing:

Azalea Autumn Belle:



IX: Walkway:

Brown Rock Stones:



X: Extra Wanted Things:

1) Mailbox:



2) Gazing Ball:



3) Isabelle Bloom "Tiny Treasures":



4) Triple Tub Bird Feeder:



5) Pink Flamingo Lawn Ornament:



Price Listings:

I. Flower Garden:	\$
Ruby Giant Coneflower:	13.00
Primadonna White:	15.00
Helleborus Royal Heritage:	13.00
Echinacea Pixie:	13.00
Agapanthus "Storm Cloud"	13.00
White Star Grass:	9.00
Chilean Jasmine:	24.00
Camelia Nuccio's Pearl:	25.00
Eureka Variegated Pink Lemon	30.00
Potentilla Fruticosa "Sunset"	25.00
II. Trees:	
Autumn Purple Ash:	37.95
Chestnut Oak:	15.45
III. Grass:	
Pennington Grass Seed:	23.98
IV. Exterior Lighting:	
Walkway Light:	65.67
Motion Light:	44.38
V. Water Device:	
Bird Bath:	39.97
Pool:	169.99
VI. Landscaping Trim:	
Brick:	33.32
VII. Outdoor Social Area:	
Table and Chairs:	269.70
Mulch:	23.94
Summer Breeze White Arbor	219.00
Round Fire Pit	149.99
Deluxe Hammock Swing	239.99
VIII. Fencing:	
Azalea Autumn Belle	144.00

IX. Walkway:
Brown Rock Stones 4.98

X. Extra:
Mailbox 52.97
Gazing Ball 17.97
Isabelle Bloom Statue 39.00
Bird Feeder 46.99
Pink Flamingos 215.56

+

Total: \$ 2,034.80